

Thank you for purchasing Metaco Pleat Net Side Fix.

Please read this instruction manual thoroughly before installing the product and keep this manual for future reference.

**SAFETY CAUTION**

For your own safety and damage to the property, this manual uses following symbols and indications. Please take a close attention and read the definition of each signs.

■ Failure to follow the operation may result in following.

**Warning**  
Improper use may result in death or serious personal injury.

**Caution**  
Improper use may result in personal injury or property damage.

■ Other symbols used in this manuals are defined as below.

You are not allowed to operate in described condition.

You must follow and operate as instructed.

## INSTRUCTION

Safety Caution, Instruction and Maintenance Procedure are listed on this front page.  
See the back page for Installation Procedure.

### Safety Instructions

#### Warning

- 
- Do not use any type of flame or fire near this product.**  
The product may catch a fire.
- 
- Do not lean yourself or any object against the product and never push with force.**  
Product may come off and may result in a fall accident.

#### Caution

- 
- Retract the insect screen, close the door and window when the wind is strong.**  
Product may come off and break resulting in injury.
- 
- Do not drop any hand tools or insect screen components.**  
Pay close attention not to drop the hand tools and insect screen components during installation. It may cause serious injury especially when working on high places.
- 
- Do not operate the product when the product is broken or not properly installed.**  
Product may come off and may result in a fall accident.
- 
- Do not operate while hands are on the bottom rail or any place other than sliding bar.**  
Your hands or fingers may get caught during operation and result in injury.
- 
- Do not operate with strong force.**  
Product may be derailed and come off if operated with strong force and result in injury.
- 
- Do not allow children to operate the product.**  
Hands and fingers may get caught with the product and result in injury. Do not let your children operate.
- 
- Do not let animals get close to the product.**  
They may scratch the net and pull the wire which may result in product breakdown. Animals can also get caught and injure themselves by the product.
- 
- Do not disassemble or modify the product.**  
Product may breakdown and not work properly. Any modification to the product will be out of warranty.

●NOTICE

**Do not use lubrication spray.**  
Dust and debris may adhere and stick.

**Do not use detergent for cleaning the product.**  
Color may change and damage the product. Do not use thinner and benzene.

**Do not use wire brush or any steel bristle to rub and clean the product.**  
It may result in product damage. Use soft cloth to wipe out the dust and debris.

### Opening and closing the screen door

Hold the center of Sliding Bar and perform the open & close operation. If you hold it too high or too low, it may affect the operation.

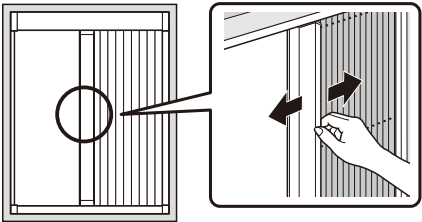

### Adjusting Procedure

#### Stiff Screen Door

Follow the steps to solve the problem.

- Top Rail and Bottom Rail are not aligned center and not paralleled.  
→Remove the unit and reinstall it again.
- Remove dirt, dust and debris on Bottom Rail.  
→Clean and remove anything that is in the way of movement.

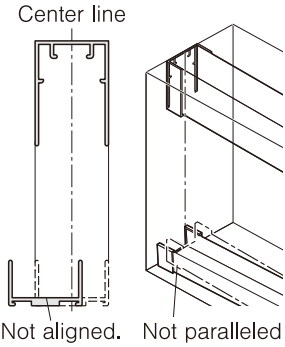

If stiffness does not improve, please go through the following procedure and adjust the wire tension.

#### Adjust the wire tension

Check the tension of wire by using a screw driver. You will need to adjust the wire when you find it too loose or tight. Adjustment should be done when screens are closed and stretched.

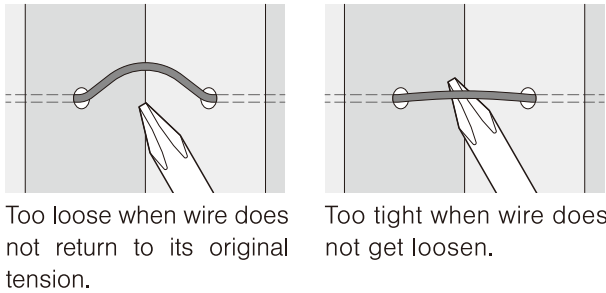
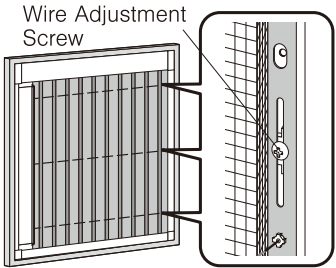

Loosen the wire adjustment screw to adjust the tension. Wire will be tighten if you move the screw away from the closest wire.  
All wires should have same wire tensions.

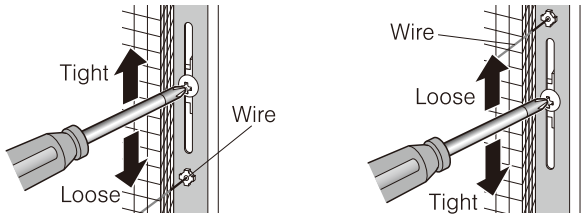

#### NOTICE

**Please handle it with care for the wire adjustment.**

Screw nut may fall off if you loosen the wire adjustment screw more than 2 turns which may cause the product malfunction. Wire adjusting process is a vey difficult process and we do not recommend when it is not necessary.  
Please keep in mind that malfunction caused by screw nut fall is out of warranty.

#### Hard to open and close the insect screen

Movement is affected by damaging or modifying the product.  
Do not drop or hit the product with hard object.  
Do not attempt to place a handle by tapping a screw in or any other way.

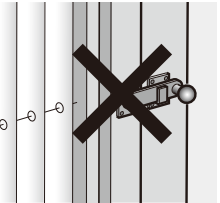

### Regular Care

#### Clean the Bottom Rail

Remove dust and debris from the Bottom Rail to keep the smooth movement.

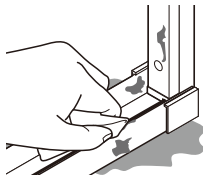

#### Wash and Clean

Clean and wipe the place where you are pouring the water on. Wipe it gently with a very soft brush.

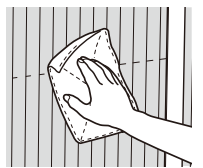

### Warranty

#### Pleated Net is damaged

Replacement of the unit is required when the net is damaged.  
Cigarbutt or any hot materials can easily make a hole to the net.  
Any sharp object can slash the wires.  
See below in case you need a replacement.

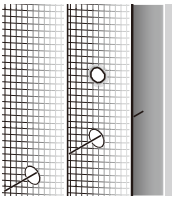

#### Replace the screen door

You can purchase the screen door only when it is damaged.  
Enter the product code and size listed in the quality control sticker on Stile Post.

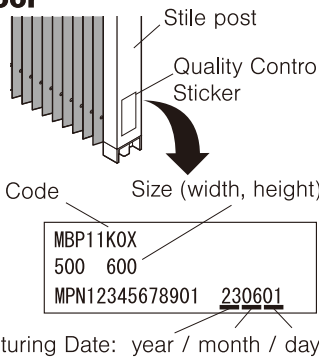

Manufacturing Date: year / month / day

### Warranty

#### 1. Warranty Period

Warranty Period - 2 years from manufacturing date.  
Manufacturing date is listed in the quality control sticker.

#### 2. Warranty Guideline

Please contact your local distributor for more information on warranty.

#### 3. Disclaimer

- Defect due to improper use and any modification to the product.
- Defect due to installation done in improper location. Installing to a location that requires higher specification.
- Defect due to reinstalling the product to different location.
- Defect due to natural disaster, such as fire, earthquake, flood, lightning, other acts of Gods.
- Defect caused by animals.
- Quality control sticker is not attached.
- Improper use of product and used other than intended purpose.
- Defect and damaged caused by fradulent or illegal acts. Contact your local distributor for information on support and service or any concern on warranty.

#### 4. Supply and support on discontinued product.

5 years after product is discontinued.

Please contact your local distributor for more information on after service and support.  
See product configuration for name of each components.  
Product design and specification are subject to change without notice.

# INSTALLATION

Please read this page thoroughly before installation.  
For safety caution, and instruction, please go through the back page.

## Configuration and part names

### Single Door

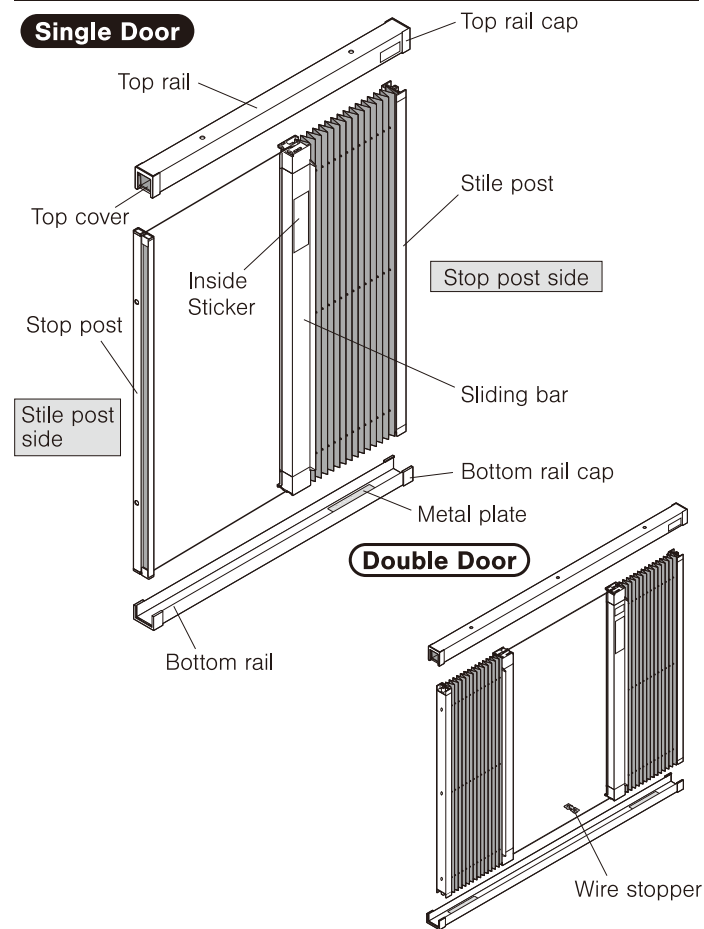

### Double Door

## Packing Details

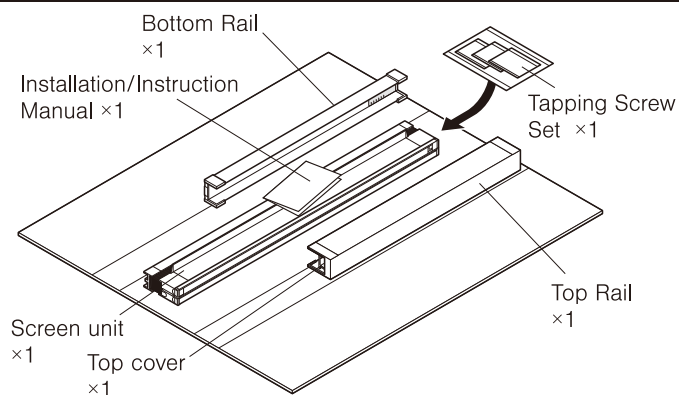

### Tapping Screw Set

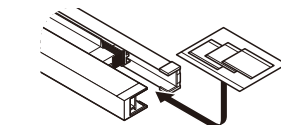

Tapping Screw Set is taped to the packing material.

Tapping Screw Binding head

Tapping Screw for Top Rail and Screen unit x9

Stopper Set (Double Door Only)



Stopper x1 Tapping Screw for stopper x2

Tapping Screw Flat head

Tapping Screw for Bottom rail x3

## Installation

### 1 Before installation

#### Check the installing location

Before attaching the unit, check and confirm the measurement of installing location.

1. Check if there is no obstacle on the frame or at the floor and if there is more than 24mm space for the installation.
2. No obstacle interferes with the insect screen installed.
3. All 4 frames are right-angled at the opening.

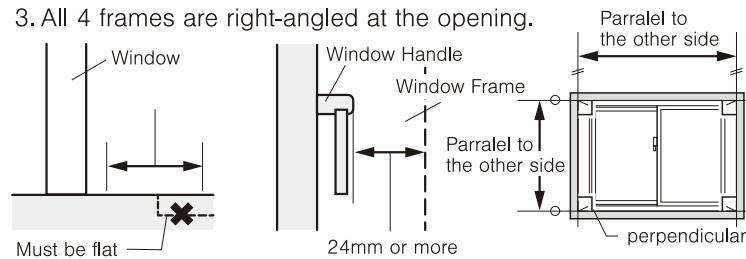

#### Clean all four sides and corners before installing the unit

Wipe away all oil residue, dust, water, sand and mud from the installation surface and the floor and then wipe these surfaces with a dry cloth to ensure that the product is installed properly.



Caution



#### Always wear working gloves during installation.

You may have a puncture wounds and cuts from aluminum profile edge without gloves.

### 2 Top Rail

1. Remove the tapes holding the top rail caps.
2. Check if the Top Rail Caps are attached to the ends of Top Rail. Push it to the end if you find it coming off.

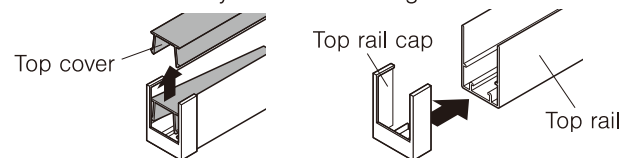

3. Fix the Top Rail with the tapping screw. Do not tighten the screw too much as it may damage the frame to bend. Slide the Top Rail Cap outwards so it touches the window frame.

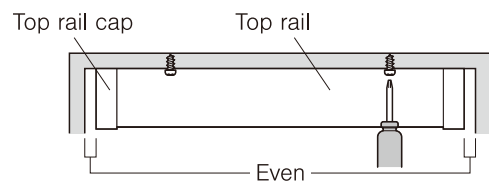

4. Slide the Top Rail Cap outwards so it touches the window frame.

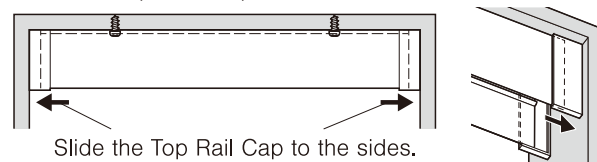

5. Push the Top Cover in the Top Rail until it gives the click sound.

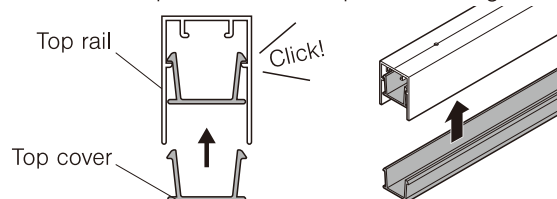

Caution



#### Do not drop any hand tools or insect screen components.

Pay close attention not to drop the hand tools and insect screen components during installation. It may cause serious injury especially when working on high places.

### 3 Bottom Rail

1. Check if the Bottom Rail Caps are attached to the ends of Bottom Rail. Push it to the end if you find it coming off.

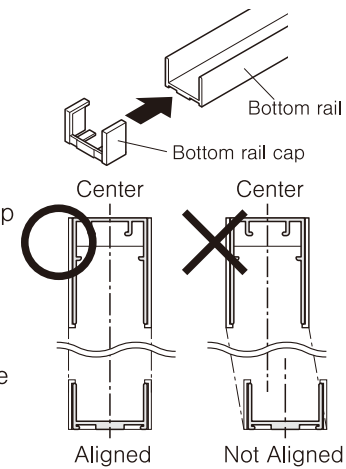

2. Align the center line of Top Rail, Stop Post and Bottom Rail. If the center line is not aligned straight it may affect the operation of product.

3. Anti-Reverse Plate is placed on one end of Bottom Rail for single door. This will be the side that Stile Post is going to be installed.

The double door has Anti-Reverse Plate placed on both end and there are no installing direction as "Stile Posts" are installed at both end.

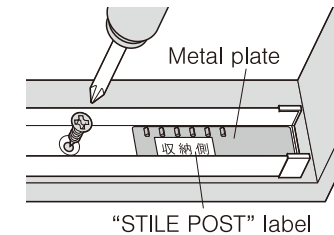

4. Fix the Bottom Rail with a Tapping Screw.

5. Pull out the bottom rail caps to cover the gaps. Once installation is completed, you can peel off this sticker.

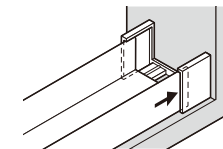
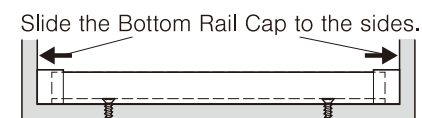

### 4-A Single Door

1. Choose the side you want your screens to retract.
2. Place in the main screen unit with sticker INSIDE facing the room.



3. Temporarily tape the retracting side as shown.

4. Fix the Stop Post with screws.

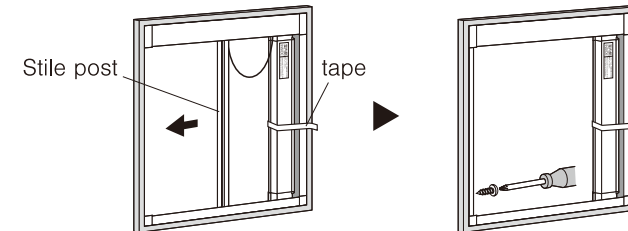

5. While fixing the unit, make sure not to loosen the wire adjusting screws. Once installation is completed, you can peel off this sticker.

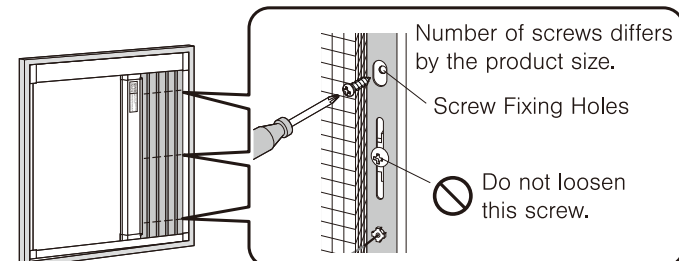

### 4-B Double door

1. Tilt in the unit with "Inside Sticker" facing the room.

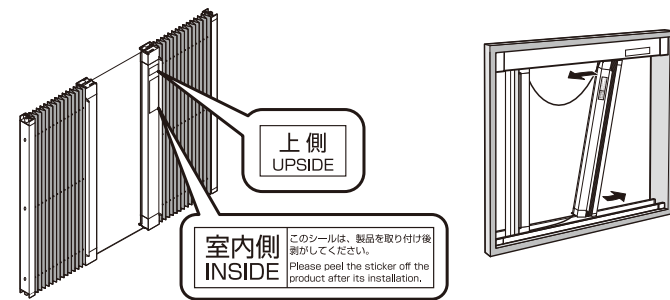

2. Tape the unit as shown. Make sure that wires are not tangled and fix the Stile Post with the Tapping screws. Again, do not loosen the wire adjusting screw.

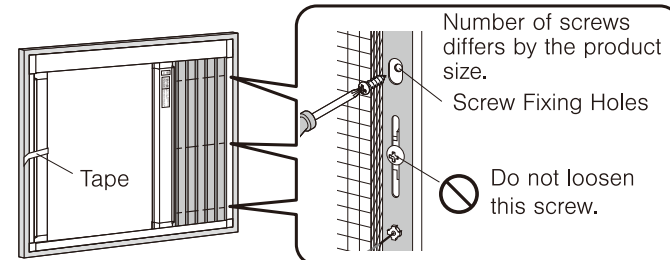

3. Place the wire stopper from above the wire at the center of bottom rail.

4. Peel off the "Inside Sticker".

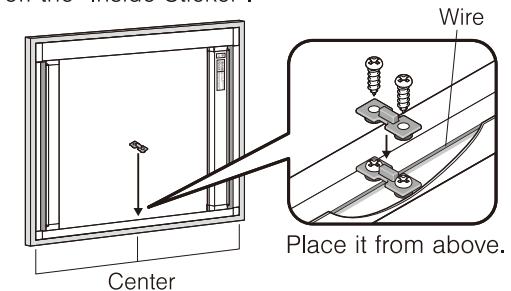

### After installation

Check the screen unit is fixed properly to the frame by moving the Stile Post back and forth.

### 5 Inspection after installation

Check the movement of the product after installation.

1. Confirm the movement by opening and closing the screen several times.
2. Confirm the Top and Bottom Rail are installed correctly.
3. Confirm if there are no damage to the aluminum profiles.
4. Confirm if there are any gap between sliding bar and stop post when closed.



Caution



#### Do not operate the product when the product is broken or not properly installed.

Product may come off and may result in a fall accident.