

Thank you for purchasing Metaco Pleat Net Side Fix.

Please read this instruction manual thoroughly before installing the product and keep this manual for future reference.

SAFETY CAUTION

For your own safety and damage to the property, this manual uses following symbols and indications. Please take a close attention and read the definition of each signs.

■ Failure to follow the operation may result in following.

	Improper use may result in death or serious personal injury.
	Improper use may result in personal injury or property damage.

■ Other symbols used in this manuals are defined as below.

	You are not allowed to operate in described condition.
	You must follow and operate as instructed.

INSTRUCTION

Safety Caution, Instruction and Maintenance Procedure are listed on this front page.
See the back page for Installation Procedure.

Safety Instructions

Warning

- Do not use any type of flame or fire near this product.**
The product may catch a fire.
- Do not lean yourself or any object against the product and never push with force.**
Product may come off and may result in a fall accident.

Caution

- Retract the insect screen, close the door and window when the wind is strong.**
Product may come off and break resulting in injury.
- Do not drop any hand tools or insect screen components.**
Pay close attention not to drop the hand tools and insect screen components during installation. It may cause serious injury especially when working on high places.
- Do not operate the product when the product is broken or not properly installed.**
Product may come off and may result in a fall accident.
- Do not operate while hands are on the bottom rail or any place other than sliding bar.**
Your hands or fingers may get caught during operation and result in injury.
- Do not operate with strong force.**
Product may be derailed and come off if operated with strong force and result in injury.
- Do not allow children to operate the product.**
Hands and fingers may get caught with the product and result in injury. Do not let your children operate.
- Do not let animals get close to the product.**
They may scratch the net and pull the wire which may result in product breakdown. Animals can also get caught and injure themselves by the product.
- Do not disassemble or modify the product.**
Product may breakdown and not work properly. Any modification to the product will be out of warranty.

NOTICE

Do not use lubrication spray.

Dust and debris may adhere and stick.

Do not use detergent for cleaning the product.

Color may change and damage the product. Do not use thinner and benzene.

Do not use wire brush or any steel bristle to rub and clean the product.

It may result in product damage. Use soft cloth to wipe out the dust and debris.

Opening and closing the screen door

Hold the center of Sliding Bar and perform the open & close operation.
If you hold it too high or too low, it may affect the operation.

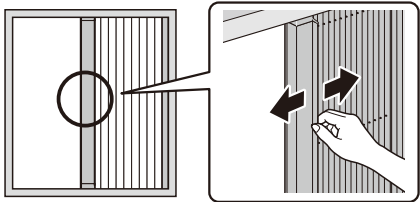

Adjusting Procedure

Adjust the wire tension

Check the tension of wire by using a screw driver. You will need to adjust the wire when you find it too loose or tight. Adjustment should be done when screens are closed and stretched.

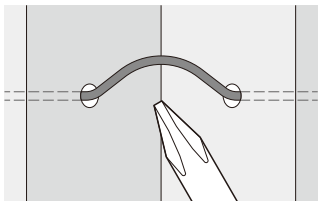

Too loose when wire does not return to its original tension.

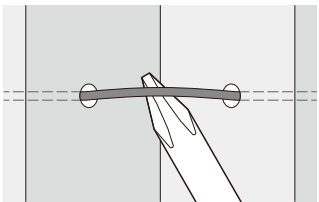

Too tight when wire does not get loosen.

Loosen the wire adjustment screw to adjust the tension. Wire will be tighten if you move the screw away from the closest wire.

All wires should have same wire tensions.

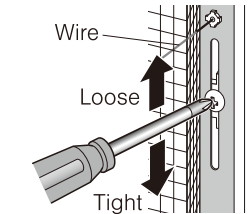
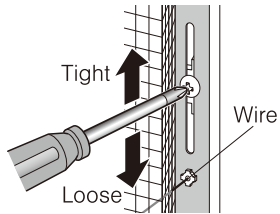
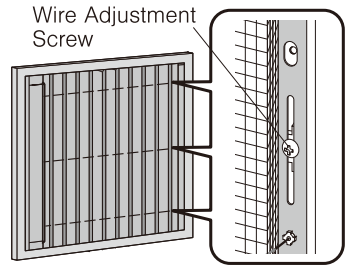

NOTICE

Please handle it with care for the wire adjustment.

Screw nut may fall off if you loosen the wire adjustment screw more than 2 turns which may cause the product malfunction. Wire adjusting process is a vey difficult process and we do not recommend when it is not necessary.
Please keep in mind that malfunction caused by screw nut fall is out of warranty.

Hard to open and close the insect screen

Movement is affected by damaging or modifying the product.

Do not drop or hit the product with hard object.

Do not attempt to place a handle by tapping a screw in or any other way.

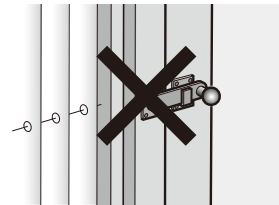

Regular Care

Clean the Bottom Rail

Remove dust and debris from the Bottom Rail to keep the smooth movement.



Wash and Clean

Clean and wipe the place where you are pouring the water on. Wipe it gently with a very soft brush.

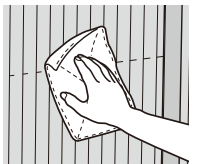

Warranty

Pleated Net is damaged

Replacement of the unit is required when the net is damaged.

Cigarbutt or any hot materials can easily make a hole to the net.

Any sharp object can slash the wires.

See below in case you need a replacement.

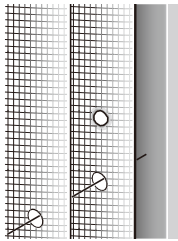

Replace the screen door

You can purchase the screen door only when it is damaged.

Enter the product code and size listed in the quality control sticker on Stile Post.

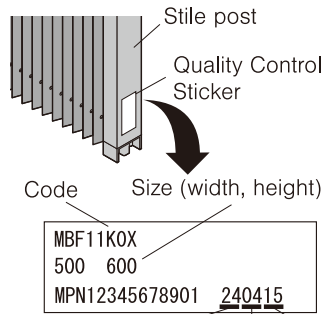

Manufacturing Date: year / month / day

Warranty

1. Warranty Period

Warranty Period - 2 years from manufacturing date.
Manufacturing date is listed in the quality control sticker.

2. Warranty Guideline

Please contact your local distributor for more information on warranty.

3. Disclaimer

- Defect due to improper use and any modification to the product.
- Defect due to installation done in improper location. Installing to a location that requires higher specification.
- Defect due to reinstalling the product to different location.
- Defect due to natural disaster, such as fire, earthquake, flood, lightning, other acts of Gods.
- Defect caused by animals.
- Quality control sticker is not attached.
- Improper use of product and used other than intended purpose.
- Defect and damaged caused by fradulent or illegal acts. Contact your local distributor for information on support and service or any concern on warranty.

4. Supply and support on discontinued product.

5 years after product is discontinued.

Please contact your local distributor for more information on after service and support.

See product configuration for name of each components.

Product design and specification are subject to change without notice.

INSTALLATION

Please read this page thoroughly before installation.
For safety caution, and instruction, please go through the back page.

Configuration and part names

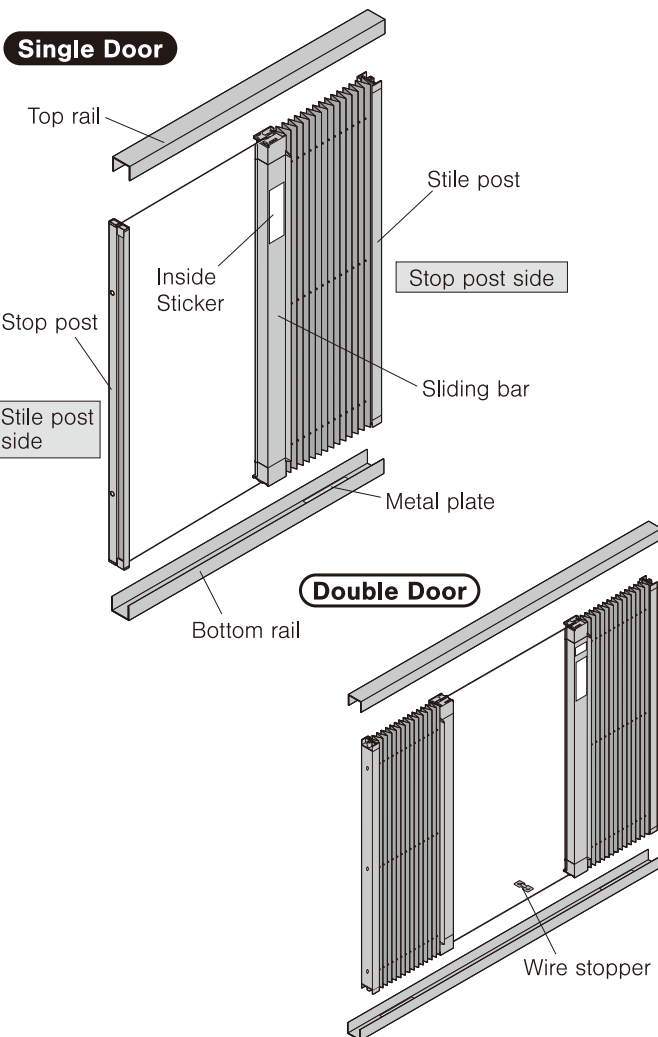

Packing Details

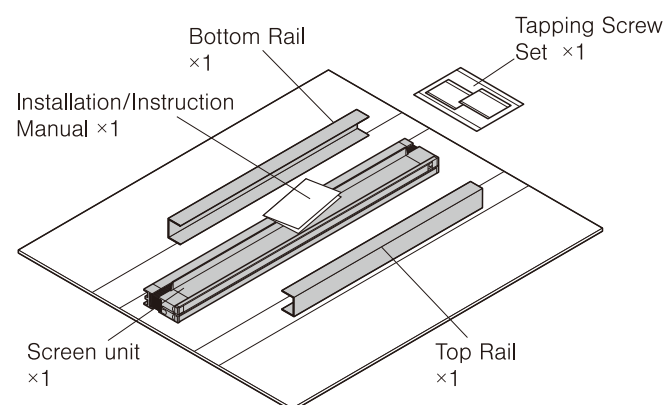

■ Tapping Screw Set

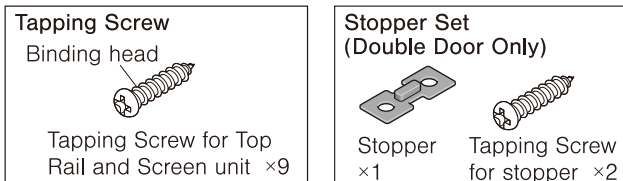

Installation

1 Before installation

■ Check the installing location

Please check the dimensions for embedding before installation and ensure the open-close movement is not affected.
The embedded dimensions of the product listed are for reference only.

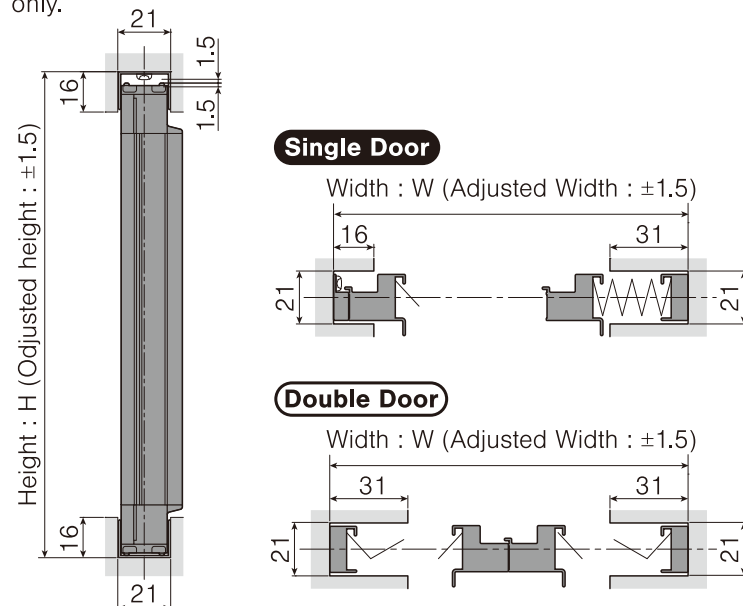

Clean all four sides and corners before installing the unit

Wipe away all oil residue, dust, water, sand and mud from the installation surface and the floor and then wipe these surfaces with a dry cloth to ensure that the product is installed properly.



2 Top Rail and Bottom Rail

- Secure the Top Rail with Tapping Screws. Fixing positions can easily be identified by the holes on the Top Rail.

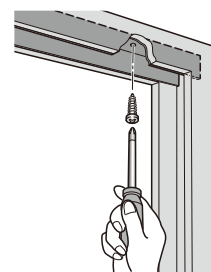

- Peel off the double-sided tape and affix the Bottom Rail to the opening.

Single Door

Metal plate "Anti-Reverse Plate" is placed at Stile Post side.

Double Door

Metal plate on both sides.

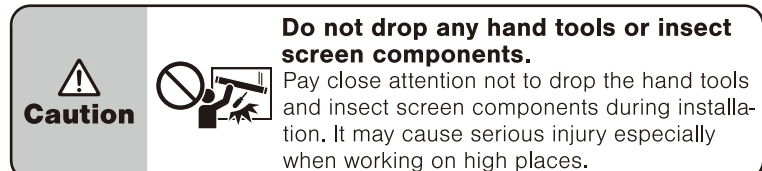
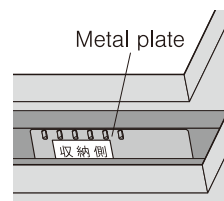

3-A Single Door

- Choose the side you want your screens to retract.
- Place in the main screen unit with sticker INSIDE facing the room.



- Temporarily tape the retracting side as shown.
- Fix the Stop Post with screws.

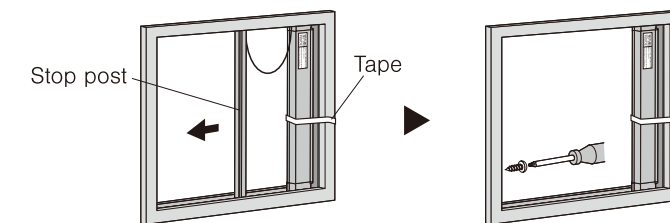

- While fixing the unit, make sure not to loosen the wire adjusting screws. Once installation is completed, you can peel off this sticker.

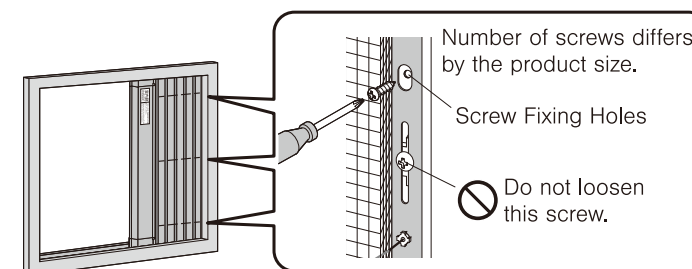

3-B Double Door

- Place the screens inside top and bottom rail. Ensure upper sticker is positioned on top facing the room before securing it.

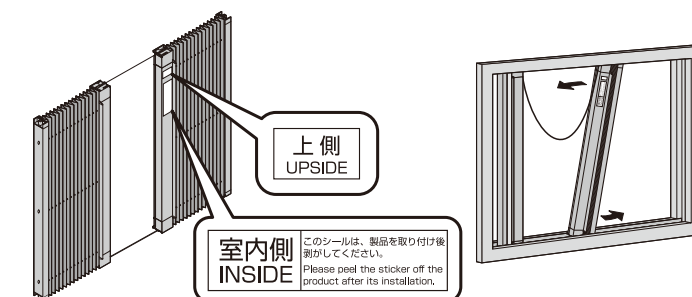

- Tape one side of the screen when securing the other side.
- Secure each stile post with tapping screw. Please do not change the position of Wire Adjusting screw.

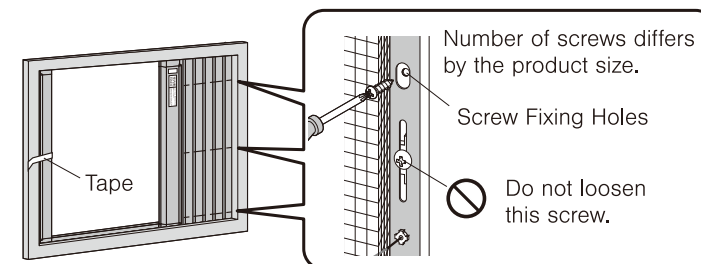

- Place the wire stopper from above the wire at the center of bottom rail.
- Peel off the "Inside Sticker".

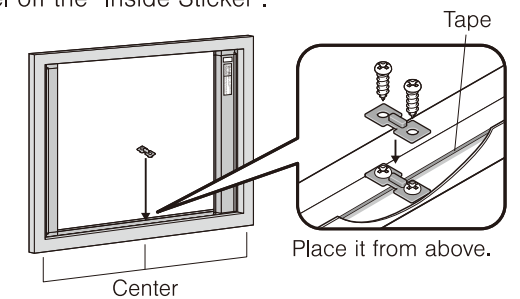

- After installation**
Check the screen unit is fixed properly to the frame by moving the Stile Post back and forth.

4 Inspection after installation

- Check the movement of the product after installation.
- Confirm the movement by opening and closing the screen several times.
 - Confirm the Top and Bottom Rail are installed correctly.
 - Confirm if there are no damage to the aluminum profiles.
 - Confirm if there are any gap between sliding bar and stop post when closed.

